

# Medley Pebble

## User Manual



 **Avantree®**

Item No.: BTHT-6126

**EN**

## Video Guide

Prefer to watch a video tutorial? Scan the QR code below or visit [avantree.com/medley-pebble/video](https://avantree.com/medley-pebble/video) for a step-by-step guide.

**DE**

## Video-Video-Anleitung

Möchten Sie lieber ein Video-Tutorial ansehen? Scannen Sie den QR-Code unten oder besuchen Sie [avantree.com/medley-pebble/video](https://avantree.com/medley-pebble/video) für eine Schritt-für-Schritt-Anleitung.

**FR**

## Guide Vidéo

Vous préférez un didacticiel vidéo? Scannez le code QR ci-dessous ou visitez [avantree.com/medley-pebble/video](https://avantree.com/medley-pebble/video) pour un guide pas à pas.

**IT**

## Videoguida

Preferisci guardare un video tutorial? Scansiona il codice QR qui sotto o visita [avantree.com/medley-pebble/video](https://avantree.com/medley-pebble/video) per una guida dettagliata.

**ES**

## Videoguía

Preferes ver un video tutorial? Escanee el código QR a continuación o visite [avantree.com/medley-pebble/video](https://avantree.com/medley-pebble/video) para obtener una guía detallada.



**EN**

## Book an Appointment

You can also book a 1-on-1 setup appointment with one of our support agents at [avantree.com/book-a-call](https://avantree.com/book-a-call)

**DE**

## Buchen Sie einen Termin

Vereinbaren Sie einen persönlichen Einrichtungstermin mit einem Support Mitarbeiter unter [avantree.com/book-a-call](https://avantree.com/book-a-call) und wählen Sie Ihre passende Zeit.

**FR**

## Prenez Rendez-Vous

Vous pouvez également réserver un rendez-vous d'installation individuel avec l'un de nos agents de support via [avantree.com/book-a-call](https://avantree.com/book-a-call)

**IT**

## Prendi un Appuntamento

Puoi anche prenotare un appuntamento con uno dei nostri agenti del supporto tecnico su: [avantree.com/book-a-call](https://avantree.com/book-a-call)

**ES**

## Haga una Cita

También puede reservar una cita con uno de nuestros agentes de soporte técnico en: [avantree.com/book-a-call](https://avantree.com/book-a-call)



# Table of Contents

<b>Box Contents</b> .....	3
<b>Product Introduction (Earphones)</b> .....	4
Product Overview.....	4
Button Functions.....	5
LED Indicators.....	5
<b>Product Introduction (Transmitter &amp; Charging Dock)</b> .....	6
Product Overview.....	6
Button Functions.....	7
LED Indicators.....	7
<b>Setting Up</b> .....	8
Connecting to Your TV.....	8
Connecting the Earphones to the Transmitter.....	10
Setting Up Your TV (For Optical Connections Only).....	12
<b>Advanced Features</b> .....	14
Using the Earphones with Your Phone.....	14
Using the Earphones with Both Phone & Transmitter.....	15
Listening with a Soundbar.....	16
<b>Specifications</b> .....	17
<b>FAQ</b> .....	19
<b>Contact Us</b> .....	92

# Box Contents

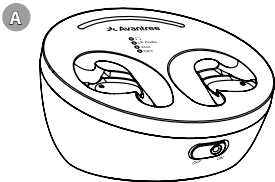

Wireless Transmitter & Charging Dock

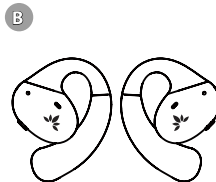

Pebble Pro Earphones

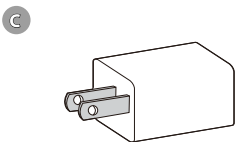

USB Wall Adapter

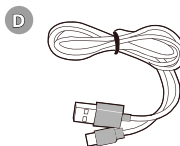

Type C Power Cable for Transmitter

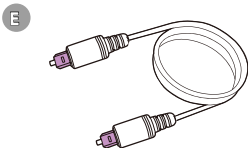

Optical Audio Cable

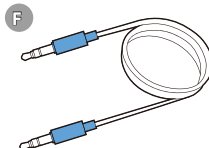

3.5mm AUX Cable

# Product Introduction (Earphones)

## Product Overview

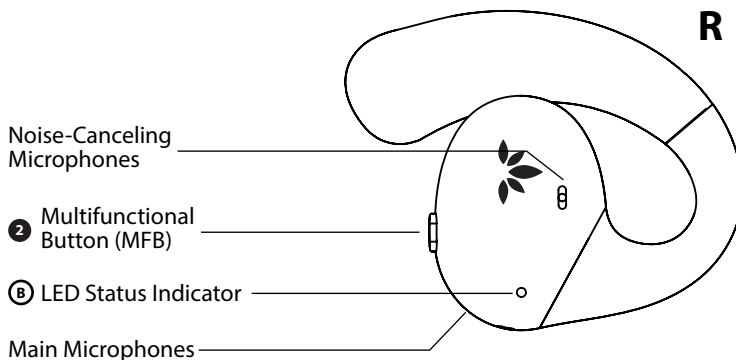
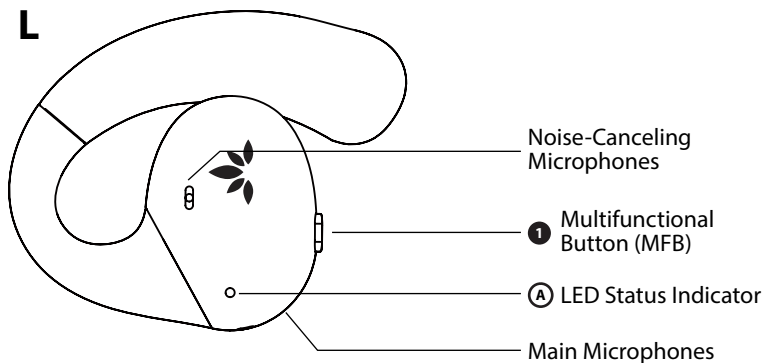

## Button Functions

No.	Button	Functions
<b>1</b> or <b>2</b>	MFB on L / R earphone	Press & hold for 5 seconds to turn on / off
		Press once to increase / decrease volume
		Press & hold for 2 seconds to switch between TV (LE audio ) & phone (Classic Bluetooth audio)
		Press once to accept an incoming call
		Press once to end an ongoing call
		Press & hold for 2 seconds to reject an incoming call

## LED Indicators

No.	Indicators & Voice Prompt	Status
<b>A</b>	Solid blue for 1 second	Power on
	Solid red for 1 second then off	Power off
	Alternate red & blue flashes, "PAIRING" voice indicator	Pairing
	Solid blue for 5 seconds then off, "CONNECTED" voice indicator	Connected
	Blue flashes every second	Disconnect
	Solid red	Charging
	LED off	Fully charged

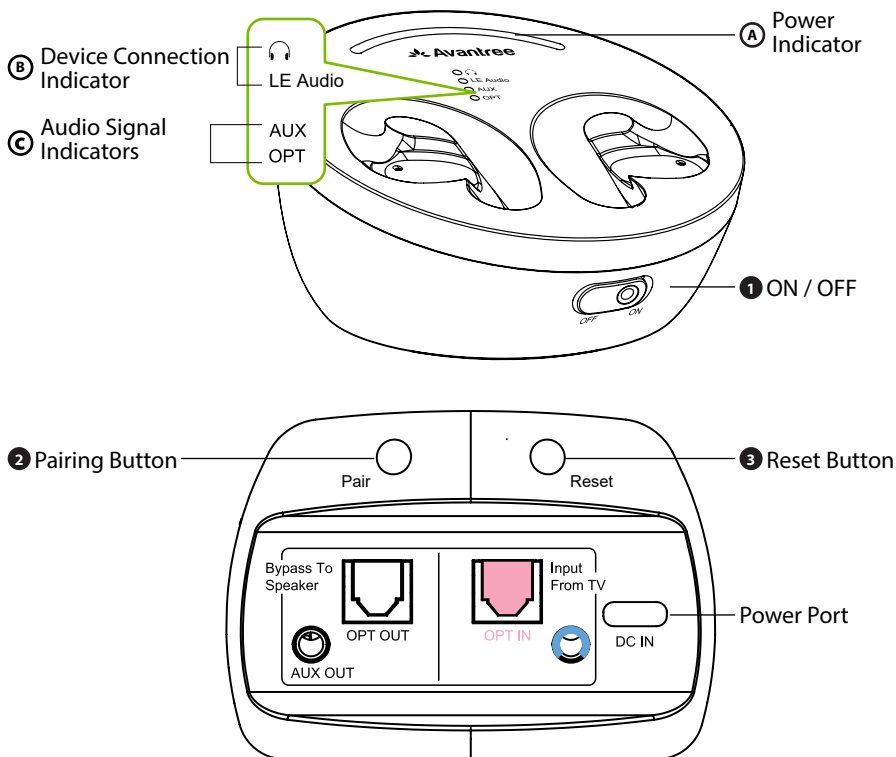

# Product Introduction (Transmitter & Charging Dock)

## Product Overview









## Button Functions

No.	Button	Functions
1	ON  OFF	Switch to "ON / OFF" position to turn the transmitter on / off
2	Pair 	Press & hold "Pair" for 3 seconds to enter pairing mode
3	 Reset	Press & hold "Reset" for 5 seconds to clear pairing history

## LED Indicators

No.	Indicators	Status
A	Solid red	Charging
	LED off	Fully charged
B	 solid blue "LE Audio" solid white	Earphones connected to transmitter, ready for use. (Earphones working in LE audio)
	 solid blue "LE Audio" off	Earphones connected to transmitter and another Bluetooth device simultaneously. (Earphones working in classic Bluetooth audio)
	 flashes red and blue alternately	Pairing mode
	 solid pink for 5 seconds	Pairing history cleared
C	Solid white	Valid audio signal
	White flashes every second	Invalid audio signal

# Setting Up

## Connecting to Your TV

The transmitter dock must be connected to a power source via the provided power cable in order to function. Plug the transmitter dock into a nearby wall outlet with the provided 5V/500mA-2A rated USB adapter.

Once the transmitter dock is connected to its power source, you can connect it to your TV. You can choose one of 2 different ways to do this:

### OPTION 1 Optical port (recommended)

Plug the provided optical audio cable into the TV's optical OUT or "OPT OUT" port, then plug the other end into the transmitter dock's optical port in the "INPUT FROM TV" section.

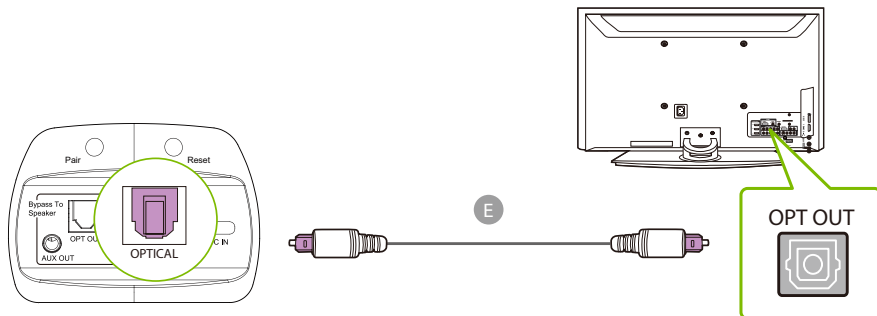

**NOTE:** Most TVs support audio output through only one digital output port at a time, so if your TV's HDMI ARC port is in use, the optical port may be disabled. You can either unplug the HDMI ARC, or try connecting the transmitter via RCA / AUX.

## OPTION 2 AUX 3.5mm port

Plug the provided AUX 3.5mm audio cable into the TV's AUX 3.5mm output port, then plug the other end into the transmitter dock's AUX 3.5mm port in the "INPUT FROM TV" section.

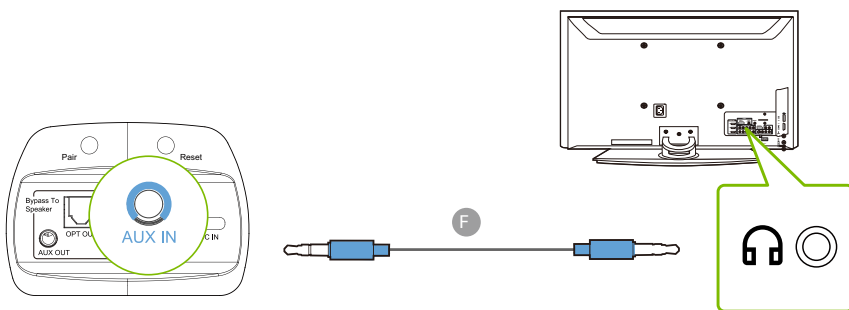

## Connecting the Earphones to the Transmitter

Now that the transmitter dock is all set up, you can connect the Pebble Pro earphones to the transmitter dock.

### STEP 1

Power on the transmitter dock by sliding the ON  OFF switch to the “ON” position. Remove the Pebble Pro earphones from the transmitter dock; they will turn on automatically.

### STEP 2

Wait for a few seconds and the Pebble Pro earphones will connect to the transmitter dock automatically. Once connected, the LED  and “LE audio” indicators on the transmitter dock will turn solid blue and white.

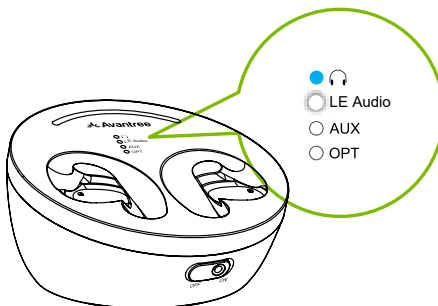

**NOTES:**

1. Both the  and “LE Audio” LED indicators will light up with solid blue & white lights respectively to indicate successful connection to the TV via the transmitter. If not, press & hold the earphones’ MFB for 2 seconds to reconnect.
2. The transmitter can only be used with the Pebble Pro earphones and cannot be connected to other Bluetooth devices.
3. Some smart TVs will automatically scan for and try to pair with any Bluetooth devices in its vicinity. If your TV prompts you to connect your Pebble Pro earphones, please “DENY” the request to avoid sound issues.

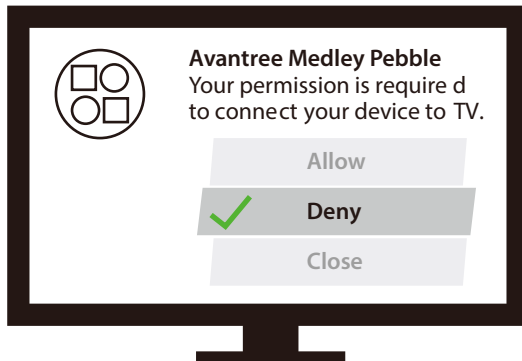

## Setting Up Your TV (For Optical Connections Only)

If you connected to your TV via the optical OUT or “OPT OUT” port, you’ll need to configure your TV settings before you’ll receive audio.

### STEP 1

Using your TV’s remote control, press the SETTINGS button and navigate to the AUDIO tab within the settings menu. (Please note that there may be differences in the setting names depending on your brand of TV).

### STEP 2

Proceed to AUDIO OUTPUT and select “OPTICAL OUT / DIGITAL OUT”. Many TVs will do this automatically; skip this step as needed.

### STEP 3

Set the AUDIO OUTPUT format to “PCM / STEREO” ON or “DOLBY” OFF.

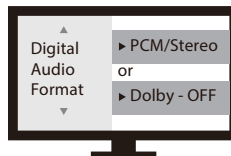
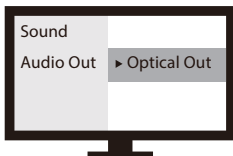

If you’re having trouble finding these settings, you can scan the QR code correlating to your TV’s brand OR visit [avantree.com/medley-pebble/tv-audio-settings](http://avantree.com/medley-pebble/tv-audio-settings) for a more detailed guide.



LG



SONY



SAMSUNG

NETFLIX/  
AMAZON PRIME**NOTES:**

1. *Smart TVs automatically reset their settings after system updates. Make sure your audio output / input format is set to "PCM" and NOT "AUTO" or "Dolby."*
2. *When using Netflix or Amazon Prime, you may need to start the movie / show before changing the audio settings to "PCM."*

# Advanced Features

## Using the Earphones with Your Phone

### STEP 1

Ensure the earphones are disconnected with the transmitter by either turning the transmitter off or maintaining sufficient distance from it. The earphones will then enter pairing mode automatically.

### STEP 2

Search for and select “Avantree Pebble Pro” in your phone’s Bluetooth menu to connect.

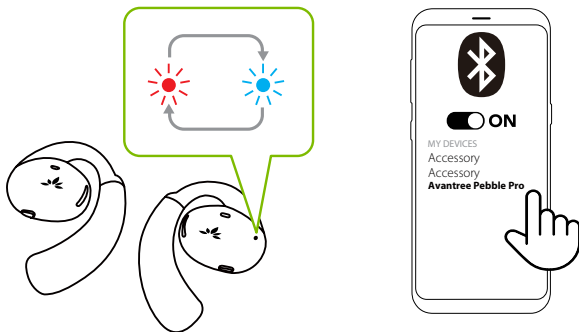

## FOR SUBSEQUENT USE

The earphones should automatically reconnect to the last-paired device within a few seconds when turn on. If not, select “Avantree Pebble Pro” in your device’s Bluetooth menu to reconnect.



## Using the Earphones with Both Phone & Transmitter

### STEP 1

Connect the earphones to your phone per the instructions above.

### STEP 2

Turn on the transmitter dock and wait for about 2 seconds, it will connect to the earphones automatically. The earphones will now be connected to your phone and transmitter simultaneously. You can:

- **Switch audio between phone** (Classic Bluetooth audio) **and TV / transmitter** (LE audio) – Press and hold the MFB button for 2 seconds, you will hear a short beep.
- **Respond to incoming calls** on your phone – Press the earphones' MFB once to accept an incoming call, or press & hold for 2 seconds to reject.

## Listening with a Soundbar

The Medley Pebble's pass-through function allows you to listen through both the headphones and an external soundbar / stereo AVR simultaneously.

### STEP 1

Plug an additional optical, 3.5mm AUX into the correlating audio port in the transmitter's "BYPASS TO SPEAKER" section.

### STEP 2

Plug the other end into your external sound system, then you're good to go.

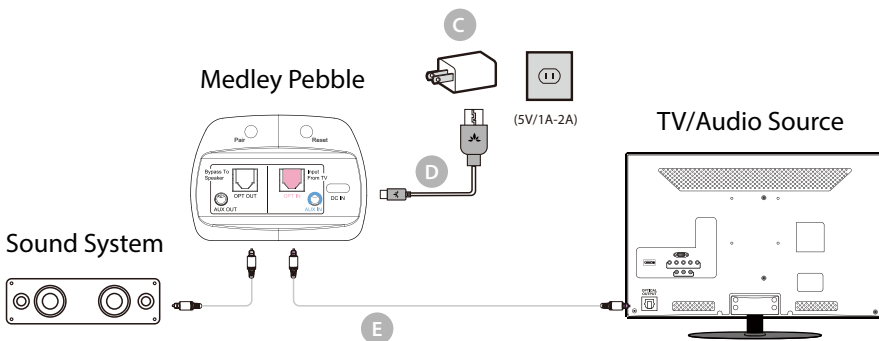

**NOTE:** Bypass only works with the same type of input / output, i.e. if you connect to your TV via OPT, you'll need to connect to your speaker via OPT as well.

# Specifications

EN

## Transmitter

Bluetooth Version	v5.3
Supported Audio Codecs	LC3
Supported Profiles	A2DP, AVRCP
Operating Range	Up to 100ft / 30m
Supported Audio Format in Optical Mode	PCM / LPCM
Power Port	Type C
Rated Input	DC5V/500mA~2.0A
Weight	190g

## Earphones

Bluetooth Version	v5.3
Supported Audio Codecs	LC3, aptX, SBC
Supported Profiles	HSP v1.2, HFP v1.7, AVRCP v1.6, A2DP v1.3
Operating Range	Up to 30ft / 10m
Playtime	Up to 10hr
Charging Time	~2hr
Drivers	16.5mm
Impedance	22Ω
Weight	26g

## FAQ

Below are some of the most common questions people have during setup.

### **Can I have audio through my TV's speakers and wireless headphones at the same time?**

This completely depends on whether or not your TV supports the ability to output audio to 2 sources simultaneously. You can try a few different methods to test if your TV is capable of this or not - please refer to [avantree.com/medley-pebble/sound](https://avantree.com/medley-pebble/sound) for more details.

For answers to questions like these and for a full FAQ list, you can visit [avantree.com/support/medley-pebble](https://avantree.com/support/medley-pebble), or you can contact us directly for additional assistance.

## Contact Us



**Support Tickets**    [avantree.com/submit-a-ticket](https://avantree.com/submit-a-ticket)

---



**Support Email**    [support@avantree.com](mailto:support@avantree.com)

---



### Support Numbers

<b>US</b>	+1 800 232 2078	9am-6pm PST	Mon-Fri
<b>CA</b>	+1 800 232 2078	9am-6pm PST	Mon-Fri
<b>UK</b>	+44 208 068 2023	9am-6pm GMT	Mon-Sat
<b>DE</b>	+49 322 2109 7297	11am-9pm CET	Mon-Sat
<b>FR</b>	+33 17 634 0312	11am-9pm CET	Mon-Sat
<b>IT</b>	+39 069 4803 330	9am-6pm CET	Mon-Sat
<b>ES</b>	+34 93 1786 261	9am-6pm CET	Mon-Sat
<b>AU</b>	+61 2 8310 9897	11am-7pm AEST	Mon-Fri

---



**FAQ**    [avantree.com/support/medley-pebble](https://avantree.com/support/medley-pebble)

---



**Product Registration**    See QR code on the product.

Manufacturer:  
Avantronics Limited  
Luohu District, Shenzhen 518000 China  
+ 86 755 8228 5022 support@avantree.com

US Importer:  
Avantree Corporation  
San Jose, California 95119 USA  
+1 800 232 2078 support@avantree.com

UK Importer:  
Avantree Limited  
Watford, WD180 0HQ UK  
+44 20 8068 2023 support@avantree.com



Servicer in Europe:  
Gizmex GmbH,  
Sternstr. 67, 40479 Dusseldorf, Germany  
+49 322 2109 7297 support@avantree.com



Model No.: BTHT-6126  
Dispose of the packaging and this product in accordance with the latest provisions.  
Z-PNT1-HT6126-V0