

Opera Plus

User Manual



Model No.: BTHT-6190P

EN

Video Guide

Prefer to watch a video tutorial? Scan the QR code below or visit avantree.com/opera-plus/video for a step by step guide.

DE

Video-Anleitung

Möchten Sie lieber ein Video Tutorial ansehen? Scannen Sie den QR Code unten oder besuchen Sie avantree.com/opera-plus/video für eine Schritt für Schritt Anleitung.

FR

Guide Vidéo

Vous préférez un didacticiel vidéo? Scannez le code QR ci dessous ou visitez avantree.com/opera-plus/video pour un guide pas à pas.

IT

Videoguida

Preferisci guardare un video tutorial? Scansiona il codice QR qui sotto o visita avantree.com/opera-plus/video per una guida dettagliata.

ES

Videoguía

Prefieres ver un video tutorial? Escanee el código QR a continuación o visite avantree.com/opera-plus/video para obtener una guía detallada.



EN

Book an Appointment

You can also book a 1-on-1 setup appointment with one of our support agents at avantree.com/book-a-call

DE

Buchen Sie einen Termin

Vereinbaren Sie einen persönlichen Einrichtungstermin mit einem Support Mitarbeiter unter avantree.com/book-a-call und wählen Sie Ihre passende Zeit.

FR

Prenez Rendez-Vous

Vous pouvez également réserver un rendez-vous d'installation individuel avec l'un de nos agents de support via avantree.com/book-a-call

IT

Prendi un Appuntamento

Puoi anche prenotare un appuntamento con uno dei nostri agenti del supporto tecnico su: avantree.com/book-a-call

ES

Haga una Cita

También puede reservar una cita con uno de nuestros agentes de soporte técnico en: avantree.com/book-a-call



Table of Contents

Box Contents	3
Product Introduction (Headphones)	4
Product Overview	4
Button Functions.....	4
LED Indicators	5
Product Introduction (Transmitter)	6
Product Overview	6
Button Functions.....	7
LED Indicators	7
Charging the Headphones & Powering the Transmitter	8
Setting up	9
Connecting to Your TV	9
Connecting the Headphones.....	12
Setting Up Your TV.....	13
Advanced Features	14
Listening with a Soundbar	14
Adding Another Pair of Headphones	15
Use the Headphones Independently with a phone.....	16
Troubleshooting	17
Specifications	18
Contact Us	91

Box Contents



Headphones

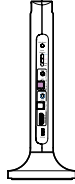

Transmitter & Charging Dock

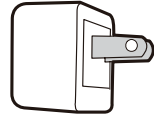

USB Adapter Dock

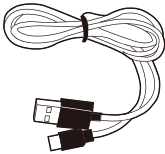

Power Cable for Transmitter

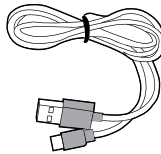

USB C Charging Cable for Headphones

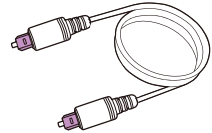

Optical Audio Cable

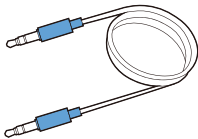

AUX 3.5mm Audio Cable

To view and purchase Opera Plus accessories, please visit avantree.com/opera-plus/accessories

Product Introduction (Headphones)

Product Overview

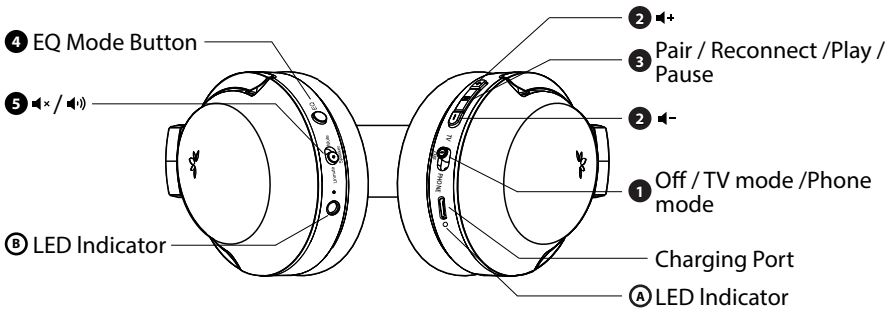

Button Functions

No.	Button	Functions
1	TV <input type="checkbox"/> OFF PHONE	<p>Switch to "TV" to connect to the transmitter, you will hear "TV mode"</p> <p>Switch to "PHONE" to connect to one's phone / tablet, you will hear "Phone mode".</p> <p>Switch to "OFF" to turn off the headphones, you will hear "Goodbye".</p>
2	\oplus \ominus	Click or hold to adjust volume.
3	\oplus \ominus	<p>If the headphones fail to reconnect, press once to reconnect.</p> <p>Press and hold to manually enter pairing mode, you will hear "pairing".</p> <p>Press once to play / pause audio (when being used with phone / tablet).</p>
4	 EQ	Press once to switch between balanced / clear voice / cinema sound modes, you will hear "balanced / clear voice / cinema sound".
5	Unmute <input type="checkbox"/> Mute Speaker	Switch to mute / unmute audio from the headphones.

LED Indicators



No.	Indicator	Status
A	Solid blue	Connected, you will hear “connected”
	Flashing blue	Reconnecting or disconnected
	Flashing red and blue	Pairing mode, you will hear “pairing”
	Solid red	Charging
	Off	Charging complete
B	Orange	Headphones muted
	Off	Unmuted

Product Introduction (Transmitter)

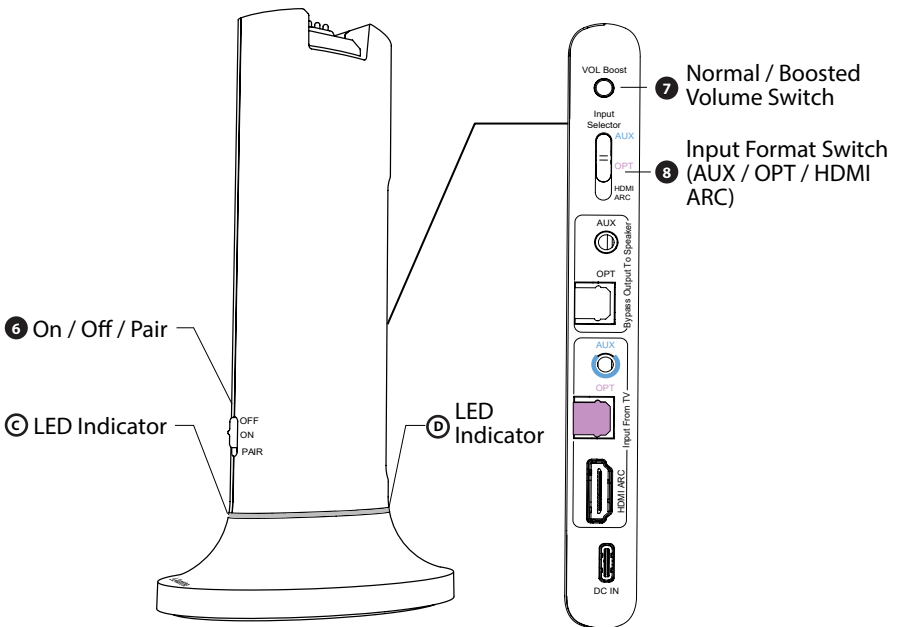
Product Overview

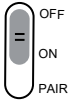

Button Functions

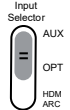
No.	Button	Functions
6		Switch to "ON / OFF" to turn the transmitter on /off
		Hold at the "PAIR" position for 5 seconds to enter pairing mode
7		Press once to switch between normal and boosted volume modes
8		Switch to match your desired audio input method

LED Indicators

No.	Indicators	Status
C	Solid blue	Connected
	Flashing red & blue	Pairing mode
	Solid red	Headphones charging
	Off	Charging complete
D	Solid white	Valid audio signal detected
	Flashing white	No valid audio signal detected; please adjust the TV's audio settings

Charging the Headphones & Powering the Transmitter

OPTION 1

Simply put the headphone back on the charging dock to recharge them. The charging dock's front LED will turn red while charging, and turn off once charging is complete. Normally, it takes about 3 hours to fully charge the headphones.

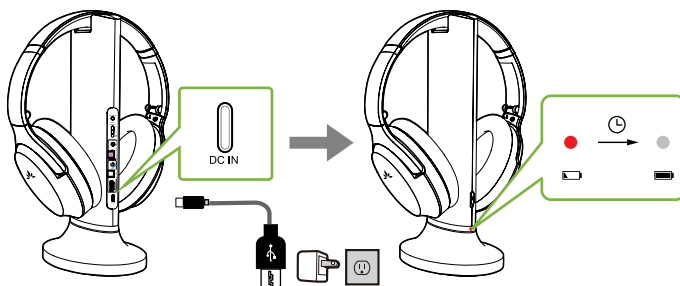

OPTION 2

You can also charge the headphones directly through their power port using a USB C charging cable and USB adapter. A solid red light indicates that charging is in progress; once the light turns off, your headphones are at full battery.

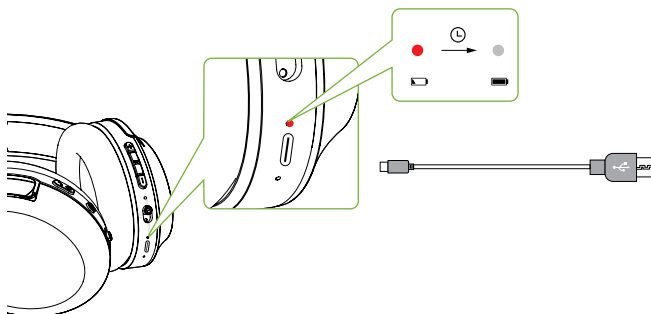

Powering the Transmitter

To power the transmitter, connect it to a wall outlet via the provided power cables and wall adapter. It doesn't hold a charge, so it needs to be connected to power in order to function.

Setting up

Connecting to Your TV

Once the transmitter is connected to a power source, next is to connect it to your TV's audio output ports. You can choose one of 4 options to do this:

OPTION 1 Optical port (Recommended)

Plug the provided optical audio cable into the TV's optical OUT or "OPT / OUT" port, then plug the other end into the transmitter's optical port in the "INPUT FROM TV" section.

On your transmitter, switch the "AUDIO INPUT SELECTOR" to the "OPT" position.

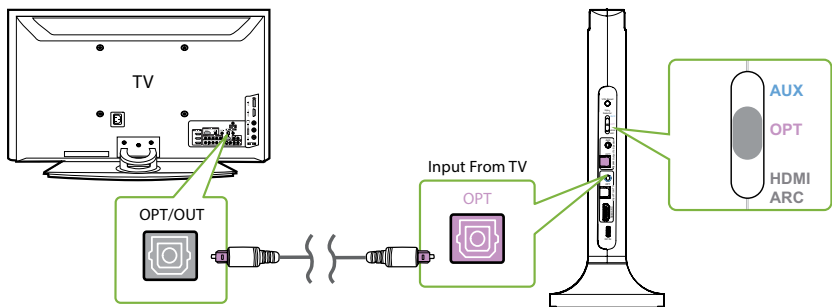

OPTION 3 AUX 3.5mm port

Plug the provided AUX 3.5mm audio cable into the TV's AUX 3.5mm output port, then plug the other end into the transmitter's AUX 3.5mm input port in the "INPUT FROM TV" section.

On your transmitter, switch the "AUDIO INPUT SELECTOR" to the "AUX" position.

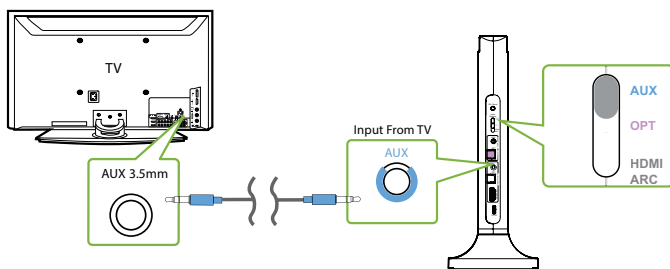
**OPTION 4** RCA port

Connect the RCA adapter to the AUX 3.5mm audio cable. Plug the red & white RCA connectors into the TV's "AUDIO OUT" ports, then plug the other end into the transmitter's AUX 3.5mm input port in the "INPUT FROM TV" section.

On your transmitter, switch the "AUDIO INPUT SELECTOR" to the "AUX" position.

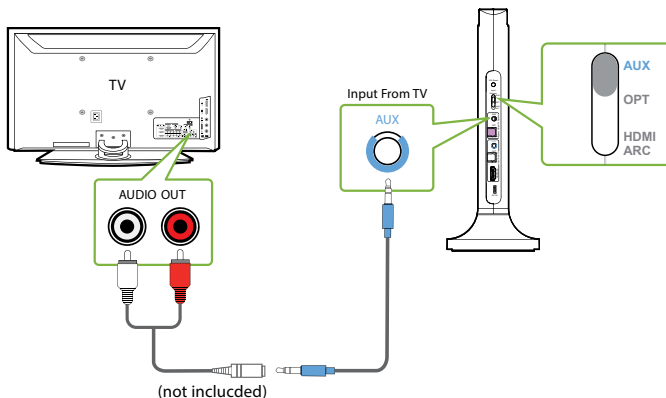

Connecting the Headphones

Now that your transmitter is set up, all that's left is to connect the headphones.

STEP 1

First, power on both the transmitter and headphones (slide to the TV position).

STEP 2

The transmitter and headphones will auto-connect. Once connected, the headphones' & transmitter's LEDs will turn solid blue.

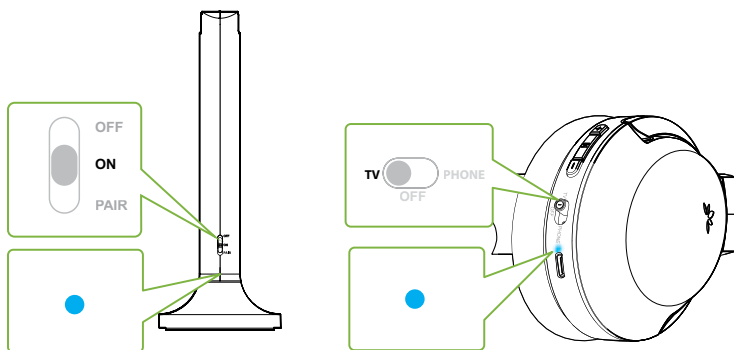

Setting Up Your TV(For Optical&HDMI ARC Connections only)

If you connected to your TV via the optical OUT, OPT / OUT or HDMI ARC port, you'll need to configure your TV settings before you receive audio.

STEP 1

Using your TV's remote control, press the SETTINGS button and navigate to the AUDIO tab within the settings menu. (Please note that there may be differences in the setting names depending on your brand of TV).

STEP 2

Proceed to AUDIO OUTPUT and select "OPTICAL OUT / DIGITAL OUT/ HDMI ARC". Many TVs will do this automatically; skip this step as needed.

STEP 3

Set Audio Output format to "PCM / STEREO" ON or "DOLBY" OFF.

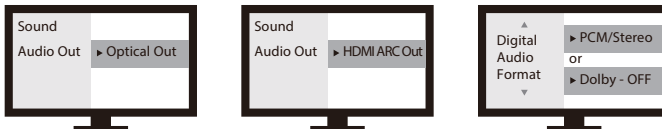

If you're having trouble finding these settings, you can scan the QR code correlating to your TV's brand OR visit avantree.com/opera/tv-audio-settings for a more detailed guide.



LG



SONY



SAMSUNG

NETFLIX/
AMAZON PRIME

NOTE 1: Smart TVs automatically reset their settings after system updates. If you're not getting sound, make sure your audio output / input format is set to "PCM" and NOT "AUTO" or "Dolby."

NOTE 2: When using Netflix or Amazon Prime, you may need to start the movie / show before changing the audio settings to "PCM."

Advanced Features

Listening with a Soundbar(Only for Optical and AUX Connection)

The pass-through function allows you to listen through both the headphones and an external soundbar / stereo AVR simultaneously.

STEP 1

Set up the transmitter and connect it to your TV.

STEP 2

Plug an additional optical, 3.5mm AUX, or RCA audio cable into the correlating audio port in the transmitter's "BYPASS OUTPUT TO SPEAKER" section.

STEP 3

Plug the other end into your external sound system, then you're good to go!

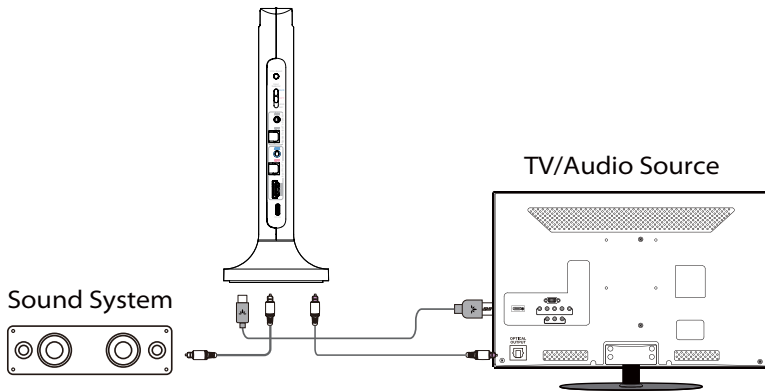

NOTE : Bypass only works with the same type of input / output, i.e. if you connect to your TV via OPT, you'll need to connect to your speaker via OPT as well.

Adding Another Pair of Headphones

You can add a second pair of Opera Plus headphones (AS90-K) to your setup while maintaining low latency.

Please note that ONLY Opera Plus headphones (AS90-K) are compatible due to private protocol connections.

STEP 1

On your transmitter, slide and hold the power switch to the "PAIR" position until the LED indicator flashes red & blue.

STEP 2

On your second pair of Opera Plus headphones, slide the power switch to the "TV" position. When using for the 1st time, it will enter pairing mode automatically, and the LED will flash red & blue alternately. If not, press and hold the  button to manually enter pairing mode.

STEP 3

Keep them close and wait for 2 seconds. Once connected, the headphones' & transmitter's LED indicators will turn solid blue.

To purchase a 2nd Opera Plus headphones (AS90-K), scan the QR code below.



Use the Headphones Independently with a phone

STEP 1

On your headphones, slide the power switch to the “PHONE” position. For the 1st time, it will enter pairing mode automatically, and the LED will flash red & blue alternately. If not, press and hold the  button for 5 seconds to manually enter pairing mode.

STEP 2

Turn on your Phone's Bluetooth and select “Avantree Opera Plus” from the Bluetooth menu.

Troubleshooting

Below are some of the most common questions people have during setup.

Can I have audio through my TV's speakers and wireless headphones at the same time?

This completely depends on whether or not your TV supports the ability to output audio to 2 sources simultaneously. You can try a few different methods to test if your TV is capable of this or not -- please refer to avantree.com/opera-plus/sound for more details.

Why don't I get sound when watching Netflix / Prime Video?

You may need to change your TV's audio settings an additional time when watching Netflix / Prime Video. This can be due to the movie being in Dolby Digital Surround Sound format, or because you're watching with a separate streaming device / cable box. While Netflix / Prime Video is open, go into your TV's audio settings and make sure that the audio output is set to "PCM / STEREO" and that "DOLBY" is turned OFF.

Why aren't my headphones connecting to the transmitter?

.....

For answers to questions like these and for a full FAQ list, you can visit avantree.com/support/opera-plus, or you can contact us directly for additional assistance.

Specifications

Transmitter & Headphones

Carrier frequency	2.4GHz
Frequency response	20Hz - 20KHz
Operating range	Up to 164ft / 50m
Power port	Type C
Input	5V/500mA-2A

Headphones

Wireless tech	2.4G RF & BT5.2
BT supported profiles	HFP 1.7, HSP 1.2, A2DP 1.3, AVRCP 1.6
Battery life	20H
Time to full charge	3H
Battery	Lithium polymer battery, 650mAh
Driver size	40mm
Impedance	32Ω
Sensitivity	96 dB
Net weight	245g

Contact Us



Support Tickets avantree.com/submit-a-ticket



Support Email support@avantree.com



Support Numbers

US	+1 800 232 2078	9am-6pm PST	Mon-Fri
CA	+1 800 232 2078	9am-6pm PST	Mon-Fri
UK	+44 208 068 2023	9am-6pm GMT	Mon-Sat
DE	+49 322 2109 7297	11am-9pm CET	Mon-Sat
FR	+33 17 634 0312	11am-9pm CET	Mon-Sat
IT	+39 069 4803 330	9am-6pm CET	Mon-Sat
ES	+34 93 1786 261	9am-6pm CET	Mon-Sat
AU	+61 2 8310 9897	11am-7pm AEST	Mon-Fri



FAQ avantree.com/support/opera-plus



Video Guide avantree.com/opera-plus/video



Product Registration See QR code on the product tag.

Manufacturer:
Avantronics Limited
Luohu District, Shenzhen 518000 China
+ 86 755 8228 5022 support@avantree.com

US Importer:
Avantree Corporation
San Jose, California 95119 USA
+1 800 232 2078 support@avantree.com

UK Importer:
Avantree Limited
Watford, WD180 0HQ UK
+44 20 8068 2023 support@avantree.com



Service in Europe:
Gizmex GmbH,
Sternstr. 67, 40479 Dusseldorf, Germany
+49 322 2109 7297 support@avantree.com



Model No.: BTHT-6190-P
Dispose of the packaging and this product in accordance with the latest provisions.
Z-PKQG-6190-P-V0